

The Tunnels, Aberdeen

Technical Specifications

March 2025

VITAL SATNAV INFO:

Due to major construction works Tunnels can only be accessed via Flourmill Lane. Turn into Flourmill Lane from Upperkirkgate then at the end of Flourmill Lane, you turn right down the hill beside The Frigate Bar onto Netherkirkgate. Head down the hill into the tunnel and The Tunnels is on the right.

Postcode: AB10 1AU

As of 1st June 2024 Aberdeen City Council intend to fine motorists with non-compliant vehicles in the LEZ.

For further information and to check your vehicle please visit: aberdeencity.gov.uk

The venue will not be held liable for any fines issued.



Venue Layout:

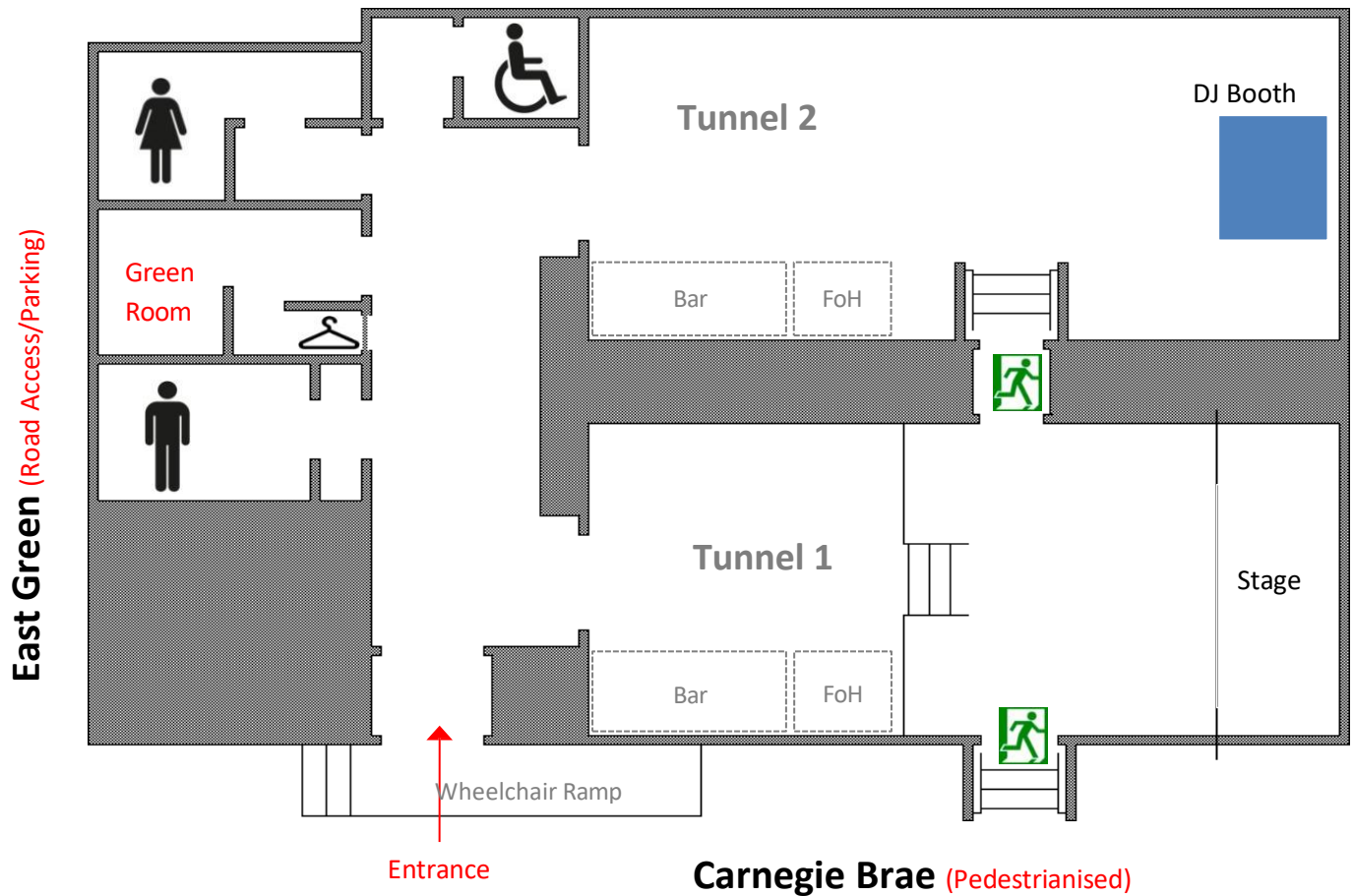

General Info:

Contact: Ross Calder (Entertainment Manager) ross840@btinternet.com
Danny Galloway 07985 463 312 (Venue Manager) dannygalloway72@outlook.com
Don Richardson 07840 340 275 (Venue Tech) richardsondon180@gmail.com

Address: The Tunnels, Carnegie Brae, Aberdeen, AB10 1BF
Satnav: Follow AB10 1AU for venue access

Room Type: Live (Room 1) - Band Orientated/Multi-Function with Stage
Club (Room 2) - DJ Orientated/General Purpose with DJ Booth

Stage Size: Tunnel 1: 6460mm x 3400mm x 1000mm

Additional: Green Room facilities include en-suite toilet and dressing room.

Tunnel 1 - Audio:

(Live/Band Room)

Main PA:	3x Logic Systems Ethos VA per side 1x Funktion One F218 mk1 per side 1x Funktion One F218 mk2 per side	(6 in total) (2 in total) (2 in total)	Flown Floor Standing Floor Standing
Monitors:	5x Logic Systems LM20 4x individual monitor mixes are available from FoH as standard.		
Amp Rack:	1x XTA DP226 System Controller 1x MC ² E25 1x MC ² E25 1x FFA 10K 1x MC ² E60 1x MC ² T-2000 1x MC ² T-2000	Main PA - HF Main PA - MF Main PA - LF Main PA - LF Monitors - 1 & 2 (Full Freq) Monitors - 3 & 4 (Full Freq)	On-Stage Rack On-Stage Rack On-Stage Rack On-Stage Rack On-Stage Rack On-Stage Rack On-Stage Rack
Stagebox:	Allen and Heath AR2412 8 way Stagebox 8 Inputs routed from one side of stage to the other/main stagebox		Stage Right
Mixer:	Allen & Heath SQ6 (Deep Comp Pack, De-esser, Dyn Eq, Multiband Comp, BB Delay) Fully featured digital mixing board Engineer has full unrestricted access to all features available. Connections available for mp3/phone/laptop playback - background music.		
DI Boxes:	2x Klark Teknik DN100 2x BSS AR-133 2x LA Audio D12	(Active) (Active) (Active)	
Venue Mics:	6x Shure SM58 5x Shure SM57 3x Sennheiser 904 1x Shure Beta 52 1x Shure Beta 57 1x Shure Beta 58		
Backline:	1x Marshall 4x10" Guitar Cabinet (NOT AN AMP) 1x H&K 4x10" Guitar Cabinet (NOT AN AMP) 1x Line 6 Spider Combo 1x Ampeg combo 1x Pearl Forum5 piece drum kit (Kit supplied with 3x cymbal stands, 1x hi-hat stand and 1x Kick pedal)		
Mic Stands:	Various short/tall type K&M and Beyer-Dynamic 3 legged boom stands. We also have 2x straight stands with circular weighted bases.		
Cables:	Various XLR mic cables of varying lengths. 4 way mains extension leads/reel. Anything more, RCA Phono/6.3mm TS/TRS Jack etc, you're best to bring them.		

Tunnel 1 - Lighting:

(Live/Band Room)

Control: 1x PC - Windows 10
Avolites Titan Go V17.1
Avolites Titan Mobile

Fixtures:	2x Strand Lighting Prelude F	①	(side spot)
	1x ETC Source Four	②	(centre spot)
	2x Showtec Fusion spot	③	(moving head)
	4x Varytec Hero Spot	④	(moving head)
	4x Varytec Hero Beam	④	(moving head)
	2x Chauvet Intimidator Spot 155	⑤	(moving head)
	2x Varytec Hero Wash	⑥	(moving head)
	2x Showtec Sunstrip Active DMX	⑦	(blinder)
	6X Sagitter Sol Par	⑧	(led par)
	1x Look Solutions Unique 2.1	⑩	(haze)
	3x Showtec Phantom Zoom 1220	⑪	(bar)
	1x lasrerworld RGB 4000 Mk2		

Tunnel 2 - Audio:

(DJ/Club Room)

Main PA:	1x D&B Audiotechnik C4 Top per side	(2 in total)	Flown
	1x D&B Audiotechnik C4 Sub per side	(2 in total)	Flown
	1x D&B Audiotechnik B2 Sub per side	(2 in total)	Floor Standing
Monitors:	2x Logic Systems LS152P		
	2x individual monitor mixes are available from FoH as standard.		
Amp Rack:	1x Void Livedrive v2 System Controller		FoH
	1x D&B Audiotechnik D12	Main PA - HF	Booth Rack
	1x D&B Audiotechnik D12	Main PA - MF	Booth Rack
	1x D&B Audiotechnik D12	Main PA - LF	Booth Rack
	1x QSC GX7	Monitors - 1 & 2 (Full Freq)	Booth Rack
Stagebox:	20 way Wall Mounted Stagebox		Booth
	8 Inputs to FoH	(2x DJ Setups)	
	2 Outputs from FoH	(Monitors)	
Mixer:	Behringer X-Air XR18		
	Fully featured digital mixer.		
	Engineer has full unrestricted access to all features available.		
	WiFi/iPad/PC/Laptop compatible.		
DI Boxes:	Connections available for mp3/phone/laptop playback - background music.		
	3x 2x BSS AR-133	(Active)	

Tunnel 2 - Lighting:

(DJ/Club Room)

Control: 2x PC - Windows 7
Avolites Titan One v11.4
ArKaos Grand VJ
Akai APC 40 mk1
OsiMIDI v2.2

Fixtures:	1x Panasonic PT-VZ580	①	(projector) out for repairs
	6x Cameo NanoBeam 600	②	(moving head)
	2x Chauvet Intimidator Spot 155	③	(moving head)
	2x Showtec Phantom 65 Spot	④	(moving head)
	2x Showtec 2 Cell Blinder	⑤	(blinder)
	1x ADJ Freq Matrix Quad	⑥	(matrix)
	1x ADJ SP-1500 DMX mk2	⑦	(strobe)
	1x Look Solutions Unique 2.1	⑧	(haze)
	1x ADJ Vizi Spot LED Pro	⑨	(moving head)